

LED TRACKLIGHT TIKI

LED TRACKLIGHT TIKI can be applied to any homes, retails and commercial areas. The Chip On Board (COB) improves the performance of the lighting and it is a cheaper solution compared to the traditional LED lighting. Furthermore, with the stylish and practical design, the track can be mounted to ceiling and walls for a decorative wall display light.



SPECIFICATIONS

- System Power : 15W, 20W, 28W, 35W & 45W
- Beam Angles : 11°, 22° & 36° - for 15W, 20W & 28W models,
12° & 28° - for 35W & 45W models
- CCT : 3000K & 4000K
- CRI90 available upon request
- Housing Color : White & Black
- IP Rating : IP20
- Connection Type : 2 wires / 3 wires (1-phase) / 4 wires (3-phase)

HIGHLIGHTS

- Easy Installation
- 4 optional anti-glare trim design accessories
- SDCM <3
- Can be fixed to most of the track available in the market
- 80% energy saving compared to traditional light sources
- Average rated lifespan of 50,000 hours
- Environmental friendly - free of mercury and hazardous
- Instant-On Light

CERTIFICATIONS

- CE
- RoHS

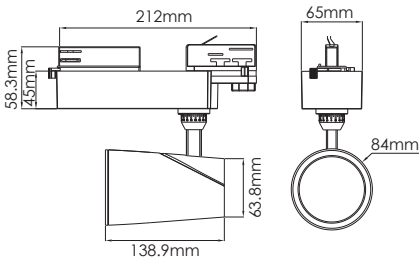

15W, 20W, 28W models
(2 wires / 3 wires / 4 wires structure)

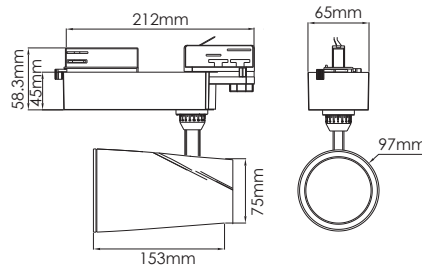

35W, 45W models
(2 wires / 3 wires structure)

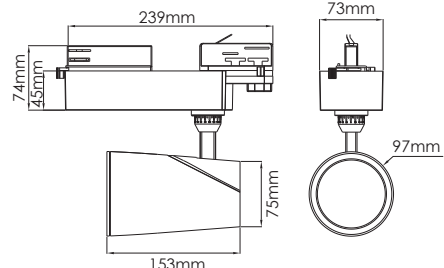

35W, 45W models
(4 wires structure)

Tolerance for dimensions = ±2.5mm

LED TRACKLIGHT TIKI Technical Specifications

System Power Consumption	CCT	Beam Angles	Optics	CRI	Voltage	Light Output	Power Factor	Article Number*
15W	3000 K	11°	Clear	80	220-240V	1270 lm	≥0.95	T2-CLE-C8W-32yX6C
15W	4000 K	11°	Clear	80	220-240V	1400 lm	≥0.95	T2-CLE-C8W-32y06C
15W	3000 K	22°	Clear	80	220-240V	1240 lm	≥0.95	T2-CLE-C9W-32yX6C
15W	4000 K	22°	Clear	80	220-240V	1360 lm	≥0.95	T2-CLE-C9W-32y06C
15W	3000 K	36°	Clear	80	220-240V	1200 lm	≥0.95	T2-CLE-D0W-32yX6C
15W	4000 K	36°	Clear	80	220-240V	1320 lm	≥0.95	T2-CLE-D0W-32y06C
20W	3000 K	11°	Clear	80	220-240V	1600 lm	≥0.95	T2-CLE-D1W-33yX6C
20W	4000 K	11°	Clear	80	220-240V	1760 lm	≥0.95	T2-CLE-D1W-33y06C
20W	3000 K	22°	Clear	80	220-240V	1600 lm	≥0.95	T2-CLE-D2W-33yX6C
20W	4000 K	22°	Clear	80	220-240V	1760 lm	≥0.95	T2-CLE-D2W-33y06C
20W	3000 K	36°	Clear	80	220-240V	1600 lm	≥0.95	T2-CLE-D3W-33yX6C
20W	4000 K	36°	Clear	80	220-240V	1760 lm	≥0.95	T2-CLE-D3W-33y06C
28W	3000 K	11°	Clear	80	220-240V	2240 lm	≥0.95	T2-CLE-D4W-34yX6C
28W	4000 K	11°	Clear	80	220-240V	2460 lm	≥0.95	T2-CLE-D4W-34y06C
28W	3000 K	22°	Clear	80	220-240V	2240 lm	≥0.95	T2-CLE-D5W-34yX6C
28W	4000 K	22°	Clear	80	220-240V	2460 lm	≥0.95	T2-CLE-D5W-34y06C
28W	3000 K	36°	Clear	80	220-240V	2240 lm	≥0.95	T2-CLE-D6W-34yX6C
28W	4000 K	36°	Clear	80	220-240V	2460 lm	≥0.95	T2-CLE-D6W-34y06C
35W	3000 K	12°	Clear	80	220-240V	3150 lm	≥0.95	T2-CLE-D7W-35yX6C
35W	4000 K	12°	Clear	80	220-240V	3470 lm	≥0.95	T2-CLE-D7W-35y06C
35W	3000 K	28°	Clear	80	220-240V	2800 lm	≥0.95	T2-CLE-D8W-35yX6C
35W	4000 K	28°	Clear	80	220-240V	3080 lm	≥0.95	T2-CLE-D8W-35y06C
45W	3000 K	12°	Clear	80	220-240V	3600 lm	≥0.95	T2-CLE-D9W-35yX6C
45W	4000 K	12°	Clear	80	220-240V	3960 lm	≥0.95	T2-CLE-D9W-35y06C
45W	3000 K	28°	Clear	80	220-240V	3600 lm	≥0.95	T2-CLE-E0W-35yX6C
45W	4000 K	28°	Clear	80	220-240V	3960 lm	≥0.95	T2-CLE-E0W-35y06C

* Options :

y = Body Color

A= Black, B= White

Note:

1. LED is a dynamic and constantly evolving technology. The final lux output of LED Tracklight TIKI may vary
2. LED Tracklight TIKI comes with an internal driver
3. The total system power consumption is with 10% tolerance under 220-240V input voltage
4. Operating temperature = Ta-20 - + 50°

LED TRACKLIGHT TIKI Radiation Pattern & Lux Diagram (CRI80)

Beam Angle : 11°		Typical Center Beam Lux (lx)					
Dist. (m)	15W 3000K	15W 4000K	20W 3000K	20W 4000K	28W 3000K	28W 4000K	
1	15682	17348	20215	22175	24910	27356	
2	3920	4337	5054	5544	6227	6839	
3	1742	1928	2246	2464	2768	3040	

Beam Angle : 22°		Typical Center Beam Lux (lx)					
Dist. (m)	15W 3000K	15W 4000K	20W 3000K	20W 4000K	28W 3000K	28W 4000K	
1	7353	8064	9400	10340	12034	13216	
2	1838	2016	2350	2585	3009	3304	
3	817	896	1044	1149	1337	1468	

Beam Angle : 36°		Typical Center Beam Lux (lx)					
Dist. (m)	15W 3000K	15W 4000K	20W 3000K	20W 4000K	28W 3000K	28W 4000K	
1	2942	3236	3813	4194	4950	5436	
2	735	809	953	1049	1238	1359	
3	327	360	424	466	550	604	

Beam Angle : 12°		Typical Center Beam Lux (lx)			
Dist. (m)	35W 3000K	35W 4000K	45W 3000K	45W 4000K	
1	36745	40462	37841	41626	
2	9186	10116	9460	10406	
3	4083	4496	4205	4625	

Beam Angle : 28°		Typical Center Beam Lux (lx)			
Dist. (m)	35W 3000K	35W 4000K	45W 3000K	45W 4000K	
1	13919	15311	17645	19409	
2	3480	3828	4411	4852	
3	1547	1701	1961	2157	

Accessories - Trims**



Name: Honeycomb
Article No.: GZ-TLT-00-Q6400C



Name: Cross
Article No.: GZ-TLT-00-Q6500C



Name: Visor
Article No.: GZ-TLT-00-Q6600C



Name: Flaps
Article No.: GZ-TLT-00-Q6700C

** Trims only used for 35W and 45W models.